

# HALF-CELL BIFACIAL MODULE LE

PE: P -B72/P, +

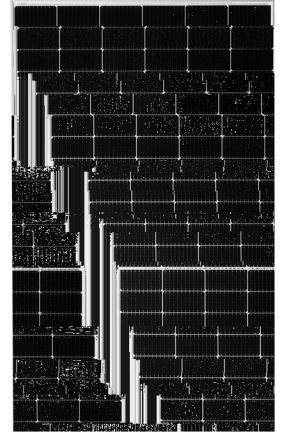

PO E Q, P,  
435-455

MA EFFICIENC  
20.9%

## Features

<p><b>H</b>igh Efficiency  <b>M</b>onocrystalline Silicon          High efficiency monocrystalline silicon cells with PERC technology.</p>	<p><b>L</b>ow Temperature Coefficient          Low temperature coefficient to ensure high performance in cold climates.</p>
<p><b>2%</b> Power Gain          2% power gain due to bifacial technology.</p>	<p><b>E</b>xtended Temperature Range          Maximum power temperature coefficient (P<sub>max</sub>) of -0.45%/°C.          Minimum power temperature coefficient (P<sub>min</sub>) of -0.25%/°C.*</p>
<p><b>E</b>xtended Temperature Range          Maximum power temperature coefficient (P<sub>max</sub>) of -0.45%/°C.          Minimum power temperature coefficient (P<sub>min</sub>) of -0.25%/°C.*</p>	<p><b>Harsh Environment</b>          High resistance to salt crystallization and corrosion.</p>

Low Temperature Coefficient \*\*

Cell Temperature Coefficient

Q<sub>max</sub> M<sub>max</sub>  
 E<sub>max</sub> M<sub>max</sub>

G<sub>max</sub> M<sub>max</sub>

---

Q. C. C.	4.0 <sup>2</sup> , (-)350 ( +)160
J. B	IP68 (3. )
Q. M. C.	-40 C. +85 C
M. DC (IEC)	1500, DC (IEC)
M. F.	20 A
P.	0/+5
.B. F.	(70 5)%
P. C.	P. ( ):2125 1130 1205 P. ( ):1067 36 P / 20'GP 792 P / 40'HC

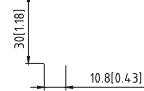

### E. C

M. P. (P / )	P. -B72/P. + C NMO	P. -B72/P. + C NMO	P. -B72/P. + C NMO	P. -B72/P. + C NMO	P. -B72/P. + C NMO
455	343.1	450	339.4	445	335.8
440	332.7	435	328.9	410	37.8
41.6	38.4	41.4	38.2	41.2	38.0
41.0	37.8	40.8	37.7	41.0	37.8
10.94	8.94	10.87	8.89	10.81	8.84
10.74	8.78	10.67	8.73	10.74	8.78
49.4	46.3	49.2	46.2	49.0	46.0
48.8	45.8	48.6	45.7	48.8	45.8
11.67	9.42	11.61	9.37	11.54	9.31
11.47	9.25	11.40	9.20	11.47	9.25
M. E (%)	20.9	20.6	20.4	20.2	20.0

C: 1000 / 2, 25 C, AM=1.5; NMO: 1 800 / 2, 20 C, AM=1.5, 1 / 2, P. +/- 3%

### D. P. G. G. & P. (455)

P. G.	5%	15%	25%
M. P. C (P )	467.3	511.8	556.3
Q. Q. ( / )	41.2	41.2	41.3
Q. Q. C. ( / A)	11.35	12.43	13.51
Q. C. ( / )	49.0	49.0	49.1
C. C. ( / A)	12.12	13.27	14.43
M. E (%)	21.4	23.5	25.5

### E. C

N. M. Q. (NMO)	42 2 C
C. P.	-0.36%/ C
C.	-0.304%/ C
C. l	0.050%/ C

